

**Series 6, Built-in oven, 60 x 60 cm,
Black
HJG852YB0T**



Included accessories

1 x combination grid
1 x universal pan
2 x universal pan
slim size
1 x air fry & grill tray

Optional accessories

HEZ327000 : Pizza stone
HEZ531010 : Baking tray, non-stick ceramic coated
HEZ532010 : Universal pan, non-stick ceramic coated
HEZ538000 : 1fold telescopic rail, level independent
HEZ629070 : Air Fry & Grill tray
HEZ634000 : Baking and roasting grid
HEZ638000 : Full ext rails, level independent
HEZ660050 : Cover Strip
HEZ664000 : Baking and roasting grid, steam
HEZ915003 : Glass roasting dish, 5,4 L
HEZG0AS00 : Connecting cable 3m

**The built-in oven with AutoPilot:
automatically prepares perfect dishes.**

- **3D Hotair:** even heat distribution for perfect results on up to three levels.
- **Auto Pilot 30:** Perfectly cooks dishes thanks to 30 pre-set automatic programmes.
- **LED Touch Control, red/white:** easy-to-use thanks to direct access to heating modes, temperature and additional functions via touch buttons
- **Eco Clean Direct:** easy cleaning thanks to a coating that breaks down grease while you bake.
- **Flap door with Soft Open and Soft Close:** the oven door opens and closes especially gently and quietly.

Technical Data

Gross weight : 37.9 kg
Built-in / Free-standing : Built-in
Integrated Cleaning system : Eco Clean program
Required niche size for installation (HxWxD) : 585-595 x 560-568 x 550 mm
Dimensions : 595x594x548 mm
Dimensions of the packed product (HxWxD) : 680 x 655 x 680 mm
Control Panel Material : Glass
Door Material : Glass
Net weight : 35.3 kg
Usable volume of cavity : 76 l
Heating modes : Air fry, Bottom heat, Conventional heat, Full width grill, Hot Air, Hotair gentle, Hot air grilling, Pizza setting
Length electrical supply cord : 120.0 cm
Interior Lights - cavity 1 : 1
Pull-out system : 2-level
Included accessories : 1 x combination grid, 1 x universal pan, 2 x universal pan, slim size, 1 x air fry & grill tray
Broil Element Wattages cavity 1 : 2800 W
Convection Element Wattages cavity 1 : 2200 W
Energy efficiency class (2010/30/EC) : A
Energy consumption per cycle conventional (2010/30/EC) : 0.98 kWh/cycle
Energy consumption per cycle forced air convection (2010/30/EC) : 0.83 kWh/cycle
Energy efficiency index (2010/30/EC) : 95.4 %
Connection Rating : 3600 W
Fuse protection : 16 A
Voltage : 220-240 V
Frequency : 50; 60 Hz
Plug type : Gardy plug w/ earthing
Energy input : Electric
Required cutout/niche size for installation (in) : x
Dimensions of the packed product : 26.77 x 25.78 x 26.77
Net weight : 78.000 lbs
Gross weight : 84.000 lbs



4 242005 495245

Series 6, Built-in oven, 60 x 60 cm, Black HJG852YB0T

**The built-in oven with AutoPilot:
automatically prepares perfect dishes.**

Type of oven / heating system:

- Oven with 8 heating methods: 3D Hotair, Conventional heat, Hot air grilling, Full width grill, Pizza setting, Bottom heat, Hotair gentle, Air fry
- Temperature range 30 °C - 275 °C
- Cavity volume: 76 l

Hook-in racks / rails

- Number of shelf levels: 5 PC
- 2 level telescopic shelf rails

Design:

- Touch control
- Cavity inner surface: enamel anthracite
- Extra large capacity oven

Cleaning:

- EcoClean Direct: coating of ceiling, back panel, side liners
- EcoClean Direct program
- Full glass inner door

Comfort:

- LED-touch control (red/white)
- Electronic clock
- Temperature proposal
Heating-up control
- AutoPilot 30
- Drop down door
- Oven door with SoftOpen and SoftClose
- Bar handle
- Supporting systems: Programs
- Halogen interior lighting, Switch for oven illumination
- Integral cooling fan

Accessory:

- 1 x air fry & grill tray, 2 x universal pan, slim size, 1 x combination grid, 1 x universal pan

Environment and Safety:

- Triple glazed door glazed CoolTouch door
- Child lock
Start-/Stop button

Technical Information

- Length of mains cable: 120 cm
- Nominal voltage: 220 - 240 V
- Total connected load electric: 3.6 KW
- Energy efficiency rating (acc. EU Nr. 65/2014): A(at a range of energy efficiency classes from A+++ to D)
Energy consumption per cycle in conventional mode:0.98 kWh
Energy consumption per cycle in fan-forced convection mode:0.83 kWh
Number of cavities: 1 Heat source: electrical Cavity volume:76 l

Dimensions:

- Appliance dimension (HxWxD): 595 mm x 594 mm x 548 mm
- Niche dimension (HxWxD): 585 mm - 595 mm x 560 mm - 568 mm x 550 mm
- "Please reference the built-in dimensions provided in the installation drawing"

Series 6, Built-in oven, 60 x 60 cm, Black HJG852YB0T

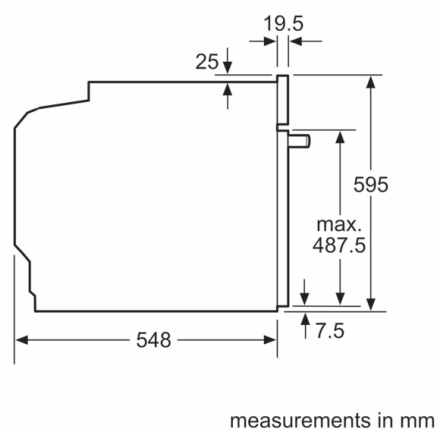
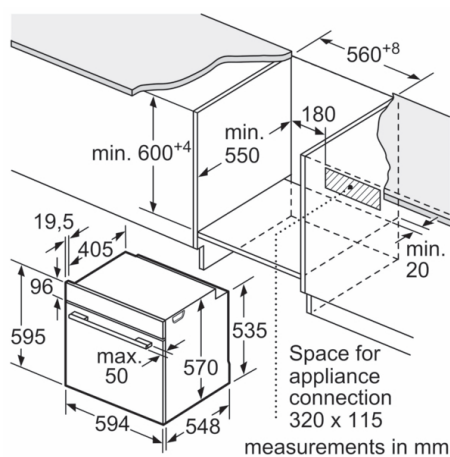

Installation with a hob.

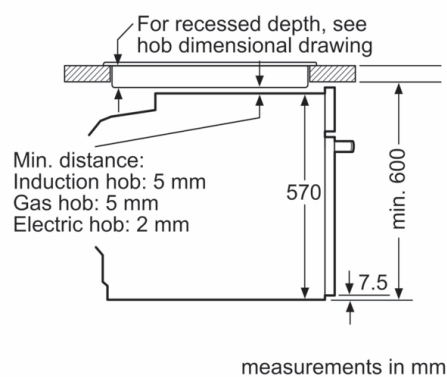

Measurements in mm

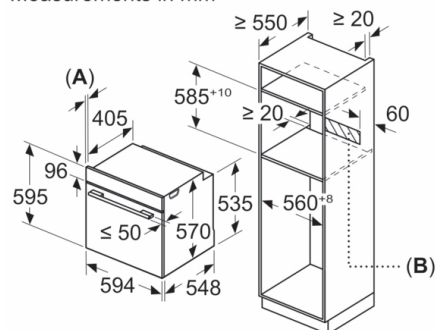

A: 19.5 mm
B: Space for appliance connection 320 x 115 mm