

## Series 4, Built-in oven, 60 x 60 cm, Black HJA737BA0



### Included accessories

1 x combination grid  
1 x universal pan  
1 x deep tray

### Optional accessories

HEZ317000 Pizza pan, enamelled, HEZ327000 Pizza stone, HEZ333001 Lid for professional pan, HEZ530000 Half tray, HEZ531000 Baking tray, enamelled, HEZ531010 Baking tray, non-stick ceramic coated, HEZ532000 Multipurpose pan, enamelled, HEZ532010 Universal pan, non-stick ceramic coated, HEZ533000 Professional pan, enamelled, HEZ538000 1fold telescopic rail, level independent, HEZ625071 Grill tray, anthracite, HEZ633001 Lid for professional pan, enamelled, HEZ633070 Professional pan with grid, enamelled, HEZ634000 Baking and roasting grid, HEZ636000 Glass pan, HEZ638000 Full ext rails, level independent, HEZ660050 Cover Strip, HEZ915003 Glass roasting dish, 5,4 L, HEZG0AS00 Connecting cable 3m

## The built-in oven with AutoPilot: automatically prepares perfect dishes.

- **3D Hotair:** even heat distribution for perfect results on up to three levels.
- **Auto Pilot 10:** every dish is a perfect success thanks to 10 pre-set automatic programmes.
- **LCD-display control, white:** easy-to-use thanks to direct access to additional functions.
- **Eco Clean Direct:** less cleaning effort thanks to a special coating of the rear wall that automatically absorbs grime.
- Cook multiple dishes simultaneously.

### Technical Data

Gross weight : 33.7 kg

Built-in / Free-standing : Built-in

Integrated Cleaning system : Eco Clean program, Hydrolytic

Required niche size for installation (HxWxD) : 585-595 x 560-568 x 550 mm

Dimensions : 595x594x548 mm

Dimensions of the packed product (HxWxD) : 680x655x680 mm

Control Panel Material : Glass

Door Material : Glass

Net weight : 31.1 kg

Usable volume of cavity : 76 l

Heating modes: : Bottom heat, Conventional heat, Full width grill, Hot Air, Hotair gentle, Hot air grilling, Pizza setting

Length electrical supply cord : 120 cm

Pull-out system : Accessory

Included accessories : 1 x combination grid, 1 x universal pan, 1 x deep tray

Broil Element Wattages cavity 1 : 2700 W

Convection Element Wattages cavity 1 : 2200 W

Energy efficiency class (2010/30/EC) : A

Energy consumption per cycle conventional (2010/30/EC) : 0.98 kWh/cycle

Energy consumption per cycle forced air convection (2010/30/EC) : 0.83 kWh/cycle

Energy efficiency index (2010/30/EC) : 95.4 %

Connection Rating : 3400 W

Fuse protection : 16 A

Voltage : 220-240 V

Frequency : 50; 60 Hz

Plug type : GARDY plug w/ earthing

Energy input : Electric

Required cutout/niche size for installation (in) : x

Dimensions of the packed product : 26.77 x 25.78 x 26.77

Net weight : 69.000 lbs

Gross weight : 74.000 lbs



## Series 4, Built-in oven, 60 x 60 cm, Black HJA737BA0

### The built-in oven with AutoPilot: automatically prepares perfect dishes.

#### Type of oven / heating system:

- Oven with 7 heating methods: 3D Hotair, Conventional heat, Hot air grilling, Full width grill, Pizza setting, Bottom heat, Hotair gentle
- Temperature range 50 °C - 275 °C
- Cavity volume: 76 l

#### Hook-in racks / rails

- Number of shelf levels: 5 PC
- Telescopic shelf rails as optional accessory

#### Design:

- Rotary Control
- Cavity inner surface: enamel anthracite
- Extra large capacity oven

#### Cleaning:

- EcoClean Direct: coating of back panel
- Cleaning Assistance (program)
- Full glass inner door

#### Comfort:

- LCD-display control (white)
- Electronic clock
- automatic start  
Heating-up control
- AutoPilot 10
- Bar handle
- Supporting systems: Programs
- Halogen interior lighting
- Integral cooling fan

#### Accessory:

- 1 x combination grid, 1 x deep tray, 1 x universal pan

#### Environment and Safety:

- low door temperature
- Child lock
- Residual heat indicator

#### Technical Information

- Length of mains cable: 120 cm
- Nominal voltage: 220 - 240 V
- Total connected load electric: 3.4 KW
- Energy efficiency rating (acc. EU Nr. 65/2014): A(at a range of energy efficiency classes from A+++ to D)  
Energy consumption per cycle in conventional mode: 0.98 kWh  
Energy consumption per cycle in fan-forced convection mode: 0.83 kWh  
Number of cavities: 1  
Heat source: electrical  
Cavity volume: 76 l

#### Dimensions:

- Appliance dimension (HxWxD): 595 mm x 594 mm x 548 mm
- Niche dimension (HxWxD): 585 mm - 595 mm x 560 mm - 568 mm x 550 mm
- "Please reference the built-in dimensions provided in the installation drawing"

## Series 4, Built-in oven, 60 x 60 cm, Black HJA737BA0

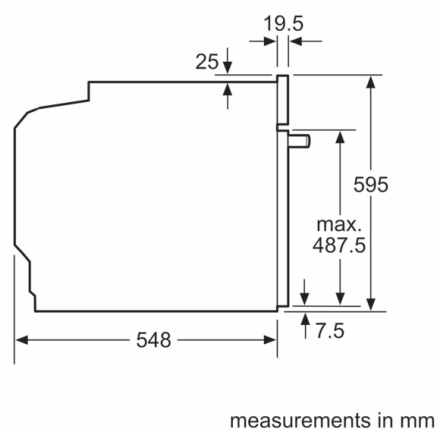
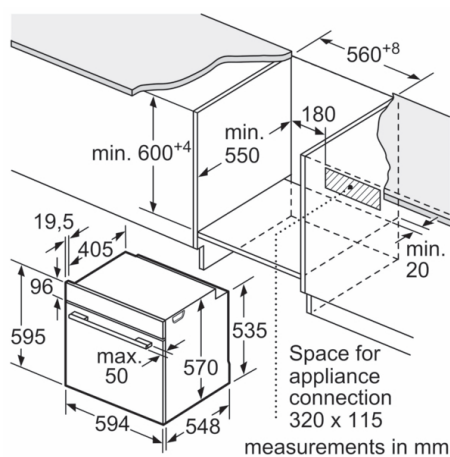

Installation with a hob.

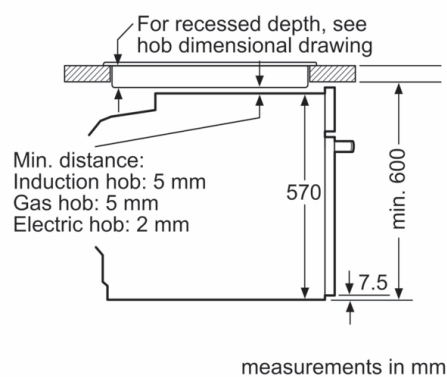

Measurements in mm

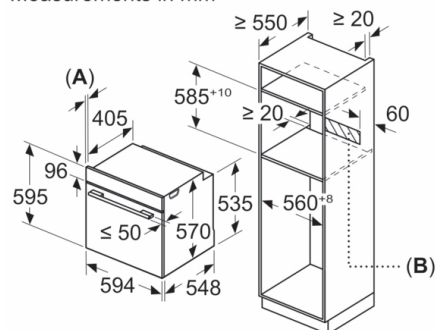

A: 19.5 mm  
B: Space for appliance connection 320 x 115 mm